

6 Option B
Typical Wingwall Elevation
1:50

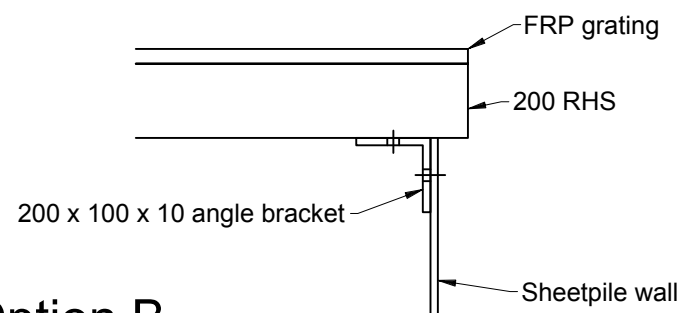

9 Option B
Section - Beam Connection
1:10

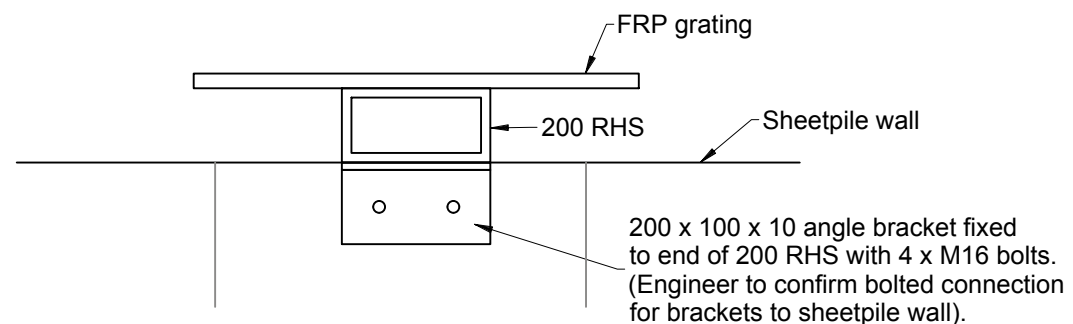

10 Option B
Detail - Beam Connection
1:10

NOTES

1. All dimensions are in millimetres unless noted otherwise.
2. Dimensions are based on site measurements and shall be verified by the Contractor prior to construction.
3. All reinforcing to be Grade 500E MA.
4. Concrete strength to be 30MPa at 28 days. Concrete exposure class B2.
5. Minimum concrete cover to be 75mm unless noted otherwise.
6. All structural steel to be Grade 300 plus.
7. All welds to be 6mm leg length fillet welds.
8. All bolts to be M16 Grade 304 stainless steel with self-locking nuts and 5mm nylon insulating washer when stainless steel bolts are in contact with mild steel.
9. All structural steel to be hot dip galvanised unless embedded in concrete.
10. Sheetpiles to be sandblasted to SSPC-SPC6 prior to casting in concrete.
11. Winch Specification:
Allquip BHW-2600 S/S with auto brake winch
Chain Specification:
Chain 6mm regular link galvanised
Pulley Specification:
S/S open pulley with pin

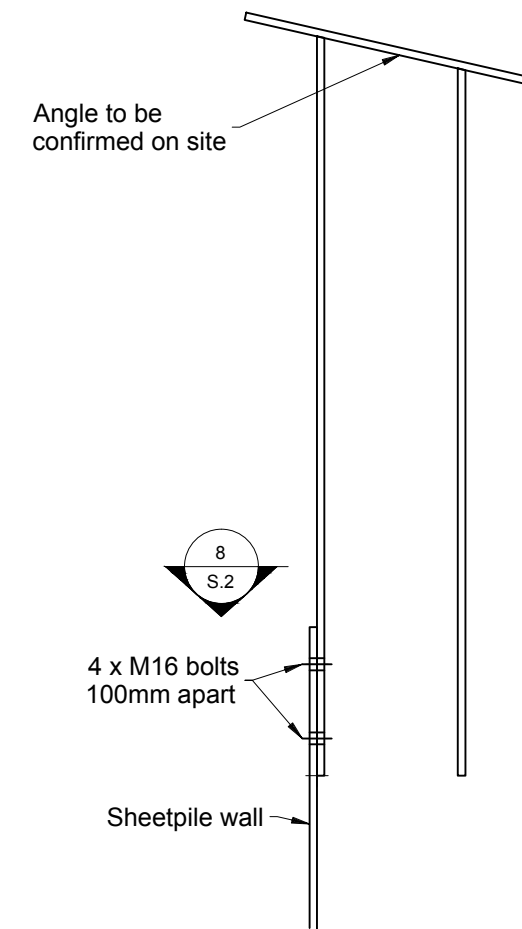

7 Option B
Detail - Winch Stand Connection
1:10

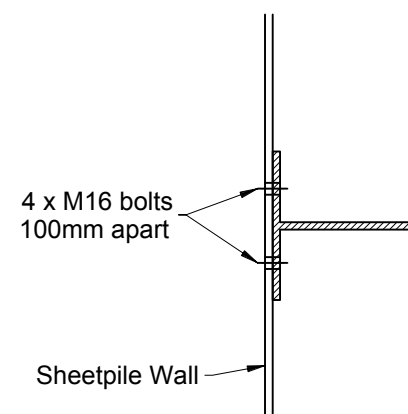

8 Option B
Section - Winch Connection
1:10

Option B: Connection to sheetpile wall

0	Construction Issue	A Morphet	29/11/19
Rev	Description	Approved	Date



Standard Drawings
Accessway, Service
Beam, Winch & Pulley

Date. 29 November 2019	Drawn. A McCaughan
	Checked. M Farrell
Drawing Number WRC-1704	REV 0
Scale. As indicated	@ A3